

Instruction Manual

Cappuccino coffee machine



CN-S



Please read this Instruction Manual and the safety instructions before operating the appliance!

Safety precautions

Keep this instruction manual

SOS In the event of an emergency: immediately remove plug from power socket.

This product has been designed for domestic use only. The manufacturer accepts no responsibility and the guarantee will not apply in the event of any commercial use, inappropriate use or failure to comply with the instructions. Remove plug from socket if not in use for long periods.

Check that the voltage quoted on the rating plate is the same as your voltage. Connect the appliance to earthed power sockets only. An improper connection voids warranty.

Before cleaning, unplug the appliance and let it cool down. Never clean with wet cloth or immerse plug, cord or appliance in any liquid.

-- This appliance can be used by children aged from 8 years and above if they have been given supervision or instruction concerning use of the appliance in a safe way and if they understand the hazards involved. Cleaning and user maintenance shall not be made by children unless they are supervised. Keep the appliance and its cord out of reach of children aged less than 8 years.

Appliances can be used by persons with reduced physical, sensory or mental capabilities or lack of experience and knowledge if they have been given supervision or instruction concerning use of the appliance in a safe way and if they understand the hazards involved. Children shall not play with the appliance. The heating element surface is subject to residual heat after use. --only to be used with the stand

--Insure that the appliance is switched off before removing it from its stand --provided.

This appliance may become a safety hazard if these instructions and safety precautions are ignored. Always close the lever, never lift it while the machine is in operation. Do not insert fingers into capsule compartment and capsule shaft, as there is a danger of injury. Do not use the appliance without the drip tray and drip grid. Keep the appliance/cord out of reach of children. Do not fill the water tank with hot water. Only use capsules intended for this appliance. If the capsule does not fit, do not force the capsule into the appliance. WARNING: To avoid the risk of injury, do not open the brew chamber during the brew process.

Product Description

Always close the lever, never lift it while the machine is in operation. Do not insert fingers into capsule compartment and capsule shaft, as there is a danger of injury. Do not use the appliance without the drip tray and drip grid. Keep the appliance/cord out of reach of children. Do not fill the water tank with hot water. Only use capsules intended for this appliance. If the capsule does not fit, do not force the capsule into the appliance. WARNING: To avoid the risk of injury, do not open the brew chamber during the brew process.

Do not place the power cord near hot parts or sharp objects, etc. Never touch the cable with wet hands. Do not unplug by pulling the cord. If it is damaged, do not use the appliance. In order to avoid any hazards, only allow the seller to repair the appliance and replace the power cord.

Do not open the appliance or insert anything into the openings. All actions other than normal use, cleaning and care must be performed by the seller.

Descaling: 8c) Do not lift lever during descaling process. 8d) Rinse the water tank and clean the machine to avoid any residual descaling agent.

Do not use the machine if it is not in perfect working order or if there is evidence of damage. In such cases inform the seller.

Place on a flat, stable and heat-resistant work surface away from water splashes and any heat sources.

This marking indicates that this product should not be disposed with other household wastes throughout the EU. To prevent possible harm to the environment or human health from uncontrolled waste disposal, recycle it responsibly to promote the sustainable reuse of material resources. To return your used device, please use the return and collection systems or contact the retailer where the product was purchased. They can take this product for environmental safety.



- Flashing slow (1*time/sec):preheating ,coffee ,rinse
- Flashing very slow : (5*sec.time):Power save mode
- Bright:ready
- (Working machine can be terminated by pressing any volume key.)
- Flashing (2*time/sec):emptying the system
- Flashing fast(3*time/sec):boiler too hot,switch OFF to reset

1 First use or after a longer period of non-use



Heating element surface is subject to residual heat after use. Do not fill hot water into the water tank. Be sure to fill the water between the Min and Max levels. Use the Appliance according to this instruction, any misuse may cause electric shock or Other hazards.

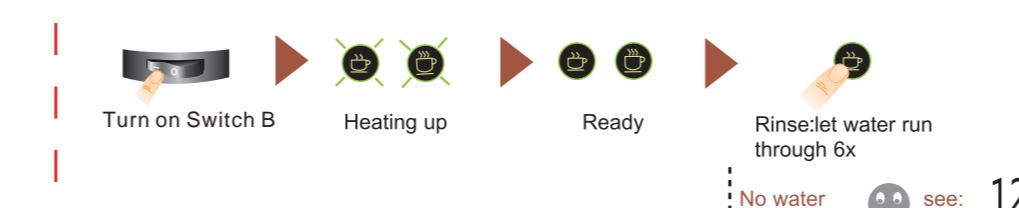

2 Daily: before the 1st coffee

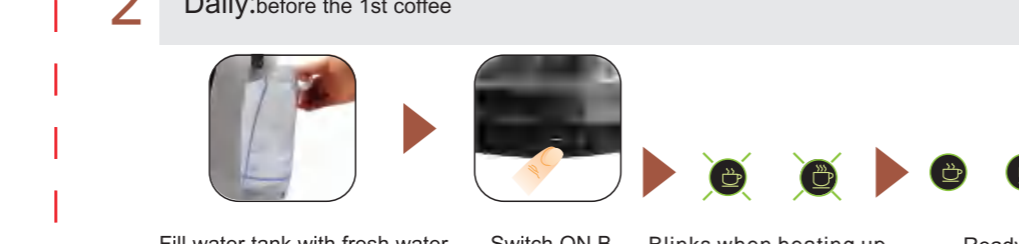

3 Espresso Lungo

Preparation (The machine apply only to indicated capsule. Please confirm it with distributor before use!)

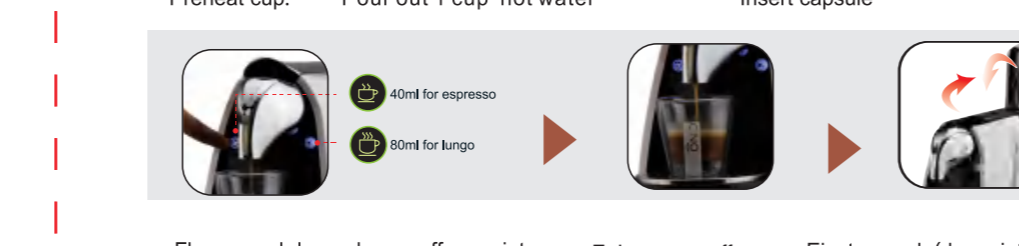
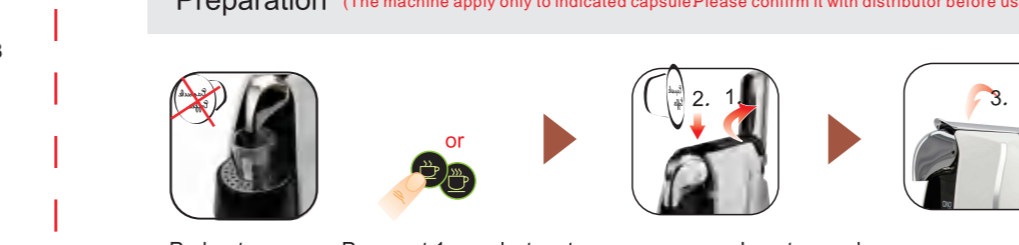

Programming the fill up level

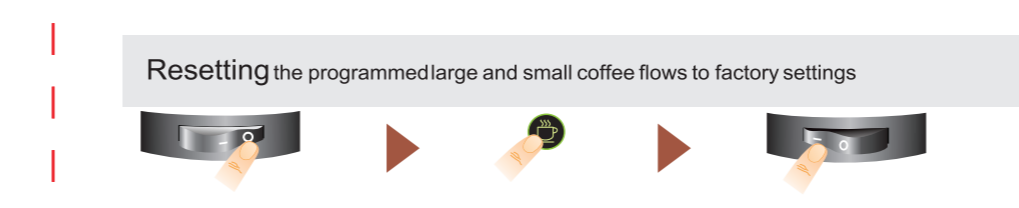

4 Milk preparation

WARNING Risk of electrical shock and fire! Make sure the underside of the milk frother is dry.

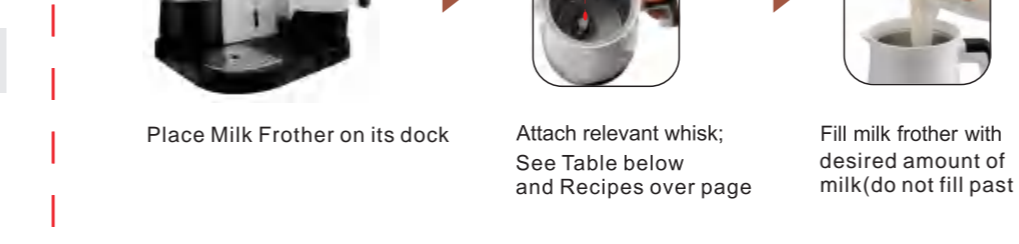
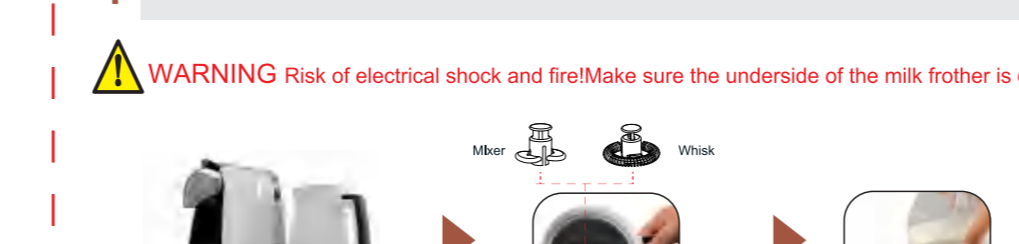

After each use, wash the inner side off any possible milk stains to avoid sintering.

TIP Use cold and newly opened, full-fat or semi-skimmed milk.

Whisk	Function	Max capacity	Time	temperature
Frothing cold milk	Frothing cold milk	80-100ml	60 s	room temperature
	Frothing & Heating	80-100ml	70 s	60 °C
Heating (a small amount of froth)	Heating	250ml	105 s	55 °C

5 Recipe ideas

- WITH FROTHED MILK**
 - Cappuccino**: 1/3 Espresso, Add 2/3 frothed milk, Top with cocoa powder.
 - Latte Macchiato**: Pour frothed milk in a tall glass, Add espresso carefully along glass rim.
- WITH HOT MILK**
 - Caffè Latte**: 1/3 espresso shot, Add 2/3 heated milk and stir.
 - Hot Chocolate**: Pour heated milk into a large mug, Add chocolate powder and stir to mix.

6 Cleaning milk frother

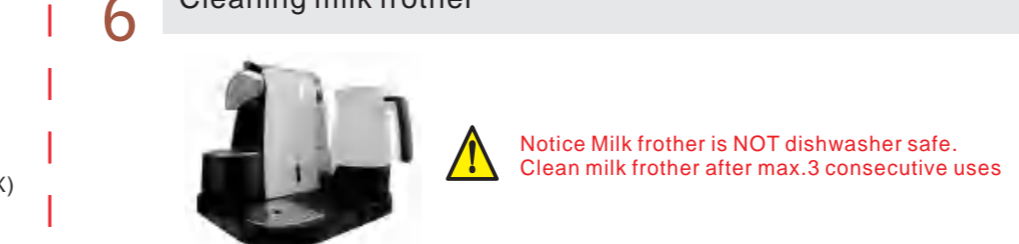

7 Power save mode (Only for coffee machine)

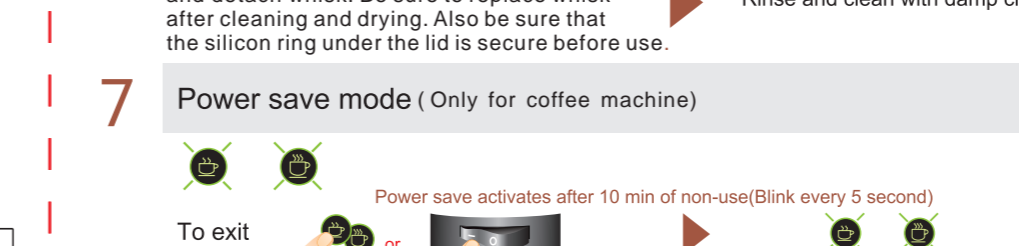

8 Daily: After the last coffee

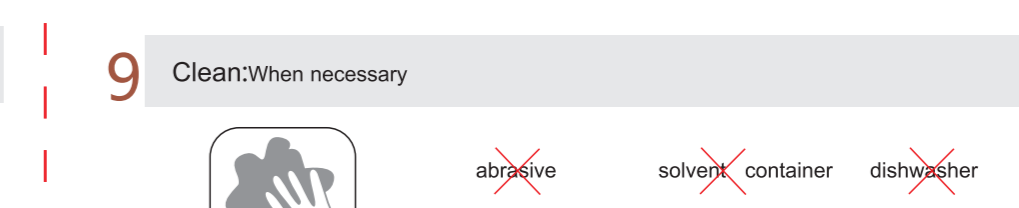
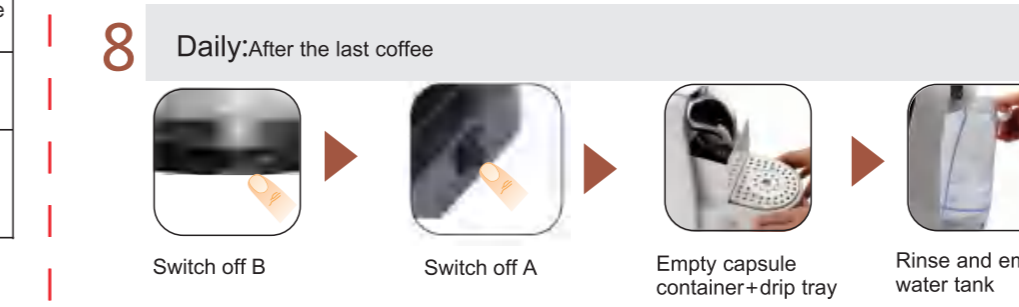

9 Clean: When necessary

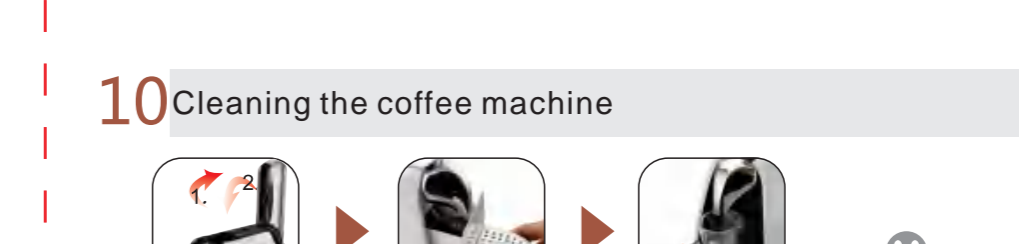

10 Cleaning the coffee machine

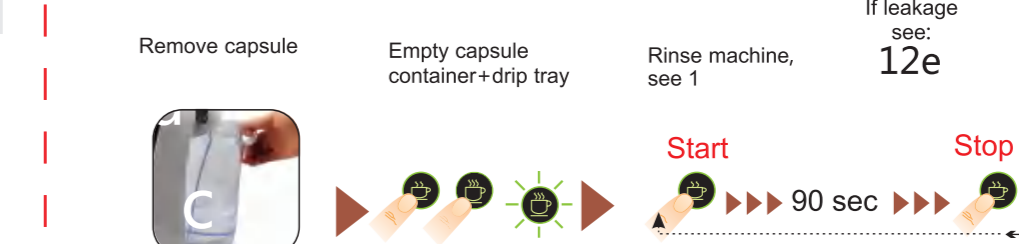

11 Empty system: After long period of non-use, for frost protection and after repair.

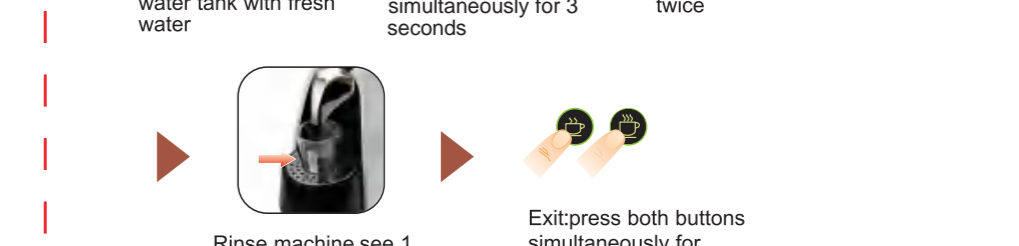

12 Troubleshooting

- a No light**: The machine has switched off automatically; press ON/OFF button. Check the mains: plug, voltage, fuse.
- b No coffee, no water**: Check the water tank. If empty, add water. Clean the machine if necessary. Lift the lever. Press one coffee button and wait until water comes out.
- c Coffee is not hot enough**: Preheat the cup. Clean the machine if necessary.
- d The lever cannot be closed completely**: Empty the capsule container/check that there is no capsule blocked inside the machine.
- e Leakage or unusual coffee flow**: Check that the water tank is in position.
- f Lights flash irregularly**: Check the water tank. If empty, add water. Replace a new capsule. Power save activates after 10 min of non-use.
- g water comes out, No coffee**: Replace a new capsule.

Specifications

Please choose the right voltage as written on the bottom label of the appliance and use the power supply accordingly.

AC220-240V 50-60Hz 1650-1900W
 AC127V 60Hz 1900W
 AC120V 60Hz 1700W
 AC110V 60Hz 1450W
 AC100V 50-60Hz 1700W

max. 15/20 bar
 4.3kg

1L
 5°C...40°C
 375mm 355mm 345mm

Please search the user manual information at www.cino.cn