

Instruction Manual

Capsule Coffee Machine

(Model:CN-R0201)

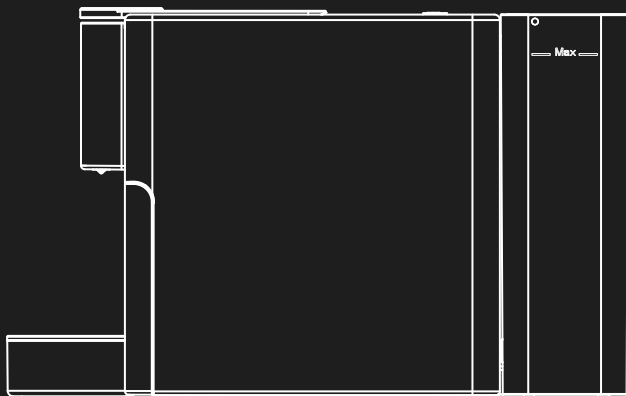

Read this instruction manual carefully before operating this machine.

Precautions



This appliance may become a safety hazard if these instructions and safety precautions are ignored.

SOS

In the event of an emergency: Immediately remove plug from power socket.



This product is intended for household and similar use only. The manufacturer accepts no responsibility and the guarantee will not apply in the event of any commercial use, inappropriate use or failure to comply with the instructions.



Before cleaning, unplug the appliance and let it cool down. Never clean with wet cloth or immerse plug, cord or appliance in any liquids.



This appliance can be used by children aged from 8 years and above if they have been given supervision or instruction concerning use of the appliance in a safe way and if they understand the hazards involved. Cleaning and user maintenance shall not be made by children unless they are aged from 8 years and above and supervised. Keep the appliance and its cord out of reach of children aged less than 8 years. This appliance can be used by persons with reduced physical, sensory or mental capabilities or lack of experience and knowledge if they have been given supervision or instruction concerning use of the appliance in a safe way and understand the hazards involved.



- Do not insert fingers into capsule compartment and capsule shaft, as there is danger of injury.
- Do not use the appliance without the drip tray and drip grid.
- Keep the appliance/cord out of reach of children.
- Do not fill the water tank with hot water.
- Do not immerse the machine in liquids. Risk of electric shock.
- Only use capsules intended for this appliance. If the capsule does not fit, do not force the capsule into the appliance.
- **WARNING:** To avoid the risk of injury, do not open the brew chamber during the brew process.



Check that the voltage quoted on the rating plate is the same as your voltage. Connect the appliance to earthed power sockets only. An improper connection voids warranty. Remove plug from socket if not in use for a long period of time.



Do not place the power cord near hot parts or sharp objects, etc. Never touch the cord with wet hands. Do not unplug by pulling the cord. Do not hang the power cord as there is danger of tripping. If it is damaged, do not use the appliance. In order to avoid any hazards, only allow the seller to repair the appliance and replace the power cord.



Do not attempt to open the appliance or insert anything into the openings. All actions other than normal use, cleaning and care must be performed by the seller. Unauthorized maintenance voids warranty.



Do not use the appliance if it is not in perfect working condition or if there is evidence of damage. In such cases inform the seller.



Place on a flat, stable and heat-resistant work surface away from water splashes and any heat sources.



Packaging materials (plastic bags etc.) are recyclable and are potential hazards. Keep them out of reach of children.



This marking indicates that this product should not be disposed with other household wastes throughout the EU. To prevent possible harm to the environment or human health from uncontrolled waste disposal, recycle it responsibly to promote the sustainable reuse of material resources. To return your used device, please use the return and collection systems or contact the retailer where the product was purchased. They can take this product for environmental safety.



It is strongly suggested that the machine be placed evenly on solid, secure and heat-resistant surface.



- Children shall not play with the appliance.
- the coffee-maker shall not be placed in a cabinet when in use.

This appliance is intended to be used in household and similar applications such as:

- staff kitchen areas in shops, offices and other working environments;
- farm houses;
- by clients in hotels, motels and other residential type environments;
- bed and breakfast type environments.

The heating element surface is subject to residual heat after use.

CONTENT

| | |
|------------------------|----|
| Product overview | 5 |
| Operating instructions | 6 |
| Functionality | 8 |
| Warning | 12 |
| Cleaning & care | 14 |
| Troubleshooting | 15 |
| Technical parameters | 16 |

Product overview

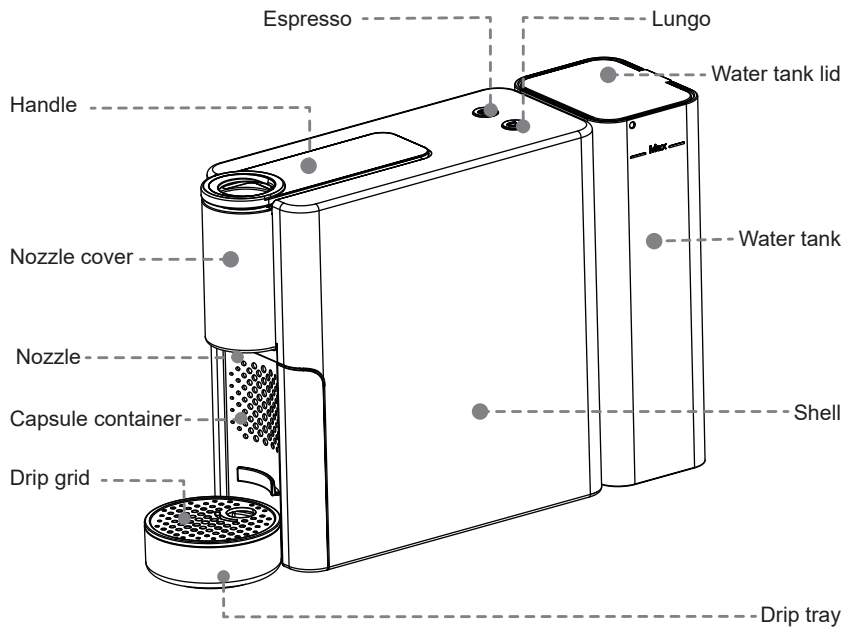

Operating instructions

1. Before Use



Fill up the water tank.

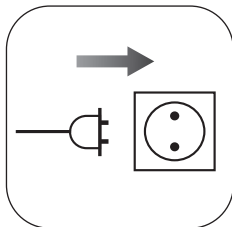

Plug power cord.

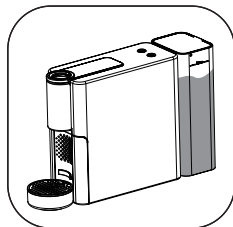

Press any button to preheat the machine.

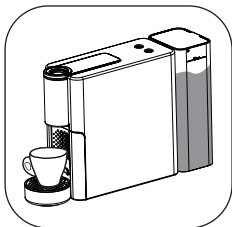

The indicator lights of Espresso and Lungo flash simultaneously at a frequency of 1 time/s. The pre-heating time is about 30s.

The machine enters standby mode after preheating.

PS: Press any button in the preheating process (this light flashes and the other light goes out), the machines will start the mode as soon as the preheating is finished.

- ▲ Do not inject hot water into the water tank, otherwise, it will cause the water tank to break, which will lead to electric shock and other dangers!
- ▲ Please note the indicated position of the highest water level (Max)!
- ▲ Only specific capsules are used on this machine. Please contact a specialized distributor before use!

2. Make your cup of coffee

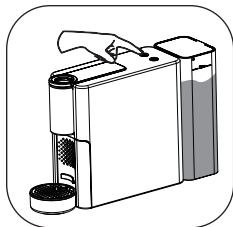

Warm up the cup: place the cup, choose Espresso or Lungo button to run a cup of water.

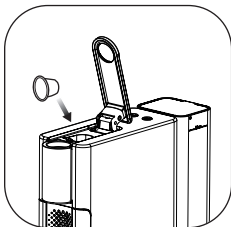

Lift the handle and insert the capsule.

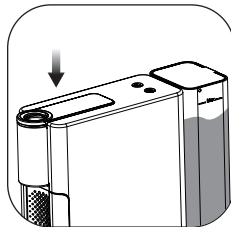

Press the handle.



Press the Espresso button, 40ml coffee brewed. The Espresso button blinks 1 time/s, the Lungo button keeps long bright. (Press any button to stop brewing coffee during this process)



Press the Lungo button, 110ml coffee brewed. The Lungo button blinks 1 time/s, the Espresso button keeps long bright. (Press any button to stop brewing coffee during this process).

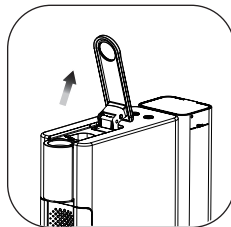

Open the handle (capsule will drop into capsule container automatically).

Functionality

1. Standby mode

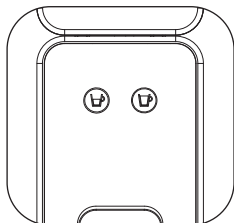

The Espresso and Lungo buttons keep long bright, the machine enters standby mode and coffee can be made at any time.

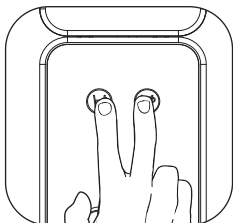

When in standby mode, long-press the lungo and espresso buttons simultaneously for 1 second, and the machine will enter power-saving mode.

2. Power-saving mode

*If power-saving mode time is too long, it will enter preheating again when switching on machine.
The power consumption is $\leq 0.5W$.*

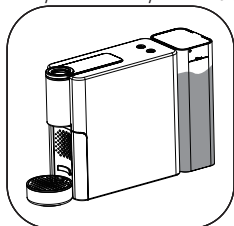

In standby mode, if the machine does not enter any instructions for 8 min, the machine enters power-saving mode.

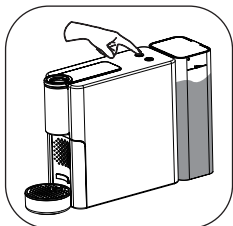

In power-saving mode, press any button to exit the mode.

3. Volume setting

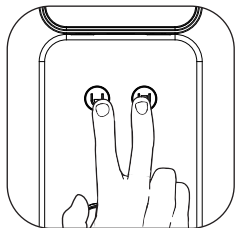

Press the lungo and espresso buttons for 5s in standby mode, two lights flash (2 times/s), Enter volume setting mode.



Press and hold the Lungo (or Espresso) button, the machine brews coffee till your desired volume is reached, then release button to finish volume setting.

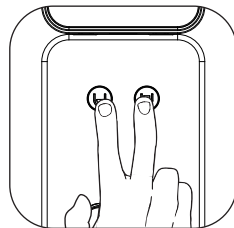

Press the Espresso and Lungo buttons simultaneously for 5s to save and exit the volume setting.

4. Factory default setting

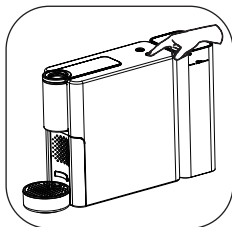

Press the Lungo button for 5s in power saving mode.

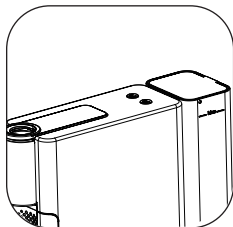

The machine will restore factory setting and enter standby mode. (The Espresso and Lungo buttons simultaneously flash 2 times, flash frequency 2 times/s.)

5. Descaling mode

▲ Descaling solution may be harmful. Keep it from eyes, skin and surface. According to water hardness, the table below shows the specific descaling frequency required to make your machine reach the optimum state. Operating time: Around 15 min. Descaling is suggested for every three months.

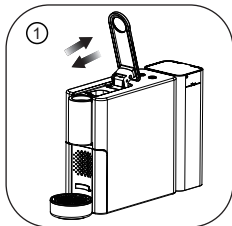

Open the handle, to enable capsule to fall into capsule container, and then, close the handle.

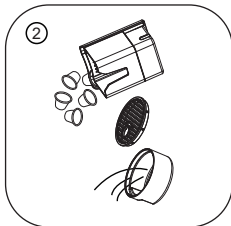

Empty waste capsule and water in drip tray and capsule container.

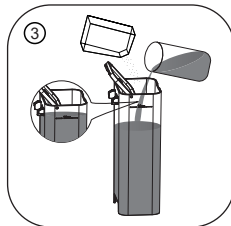

According to instructions, mix the descaling agent and water into water tank, until reach the Max water level. (around 800 ml)

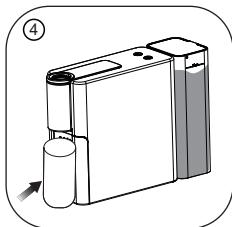

Place a container with a volume larger than 800ml below nozzle.

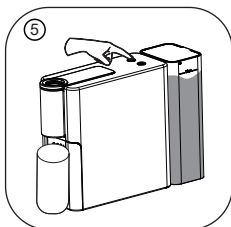

Under power saving mode, long press the Espresso button for 5s, to enter descaling mode. At this time, the indicator will be on and flash (2 times/s).

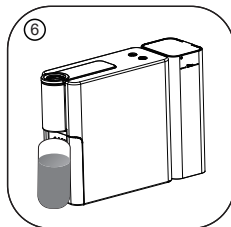

Press any button to start descaling, until water in tank is fully drained.



Refill the water tank with the descaling agent and water to the Max, repeat Step 6, until water tank is fully drained.

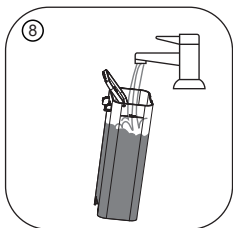

Rinse water tank and then fill it with drinking water.

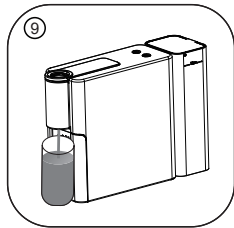

Repeat Step 6 (repeat twice, to clear remaining descaling agent in the machine).

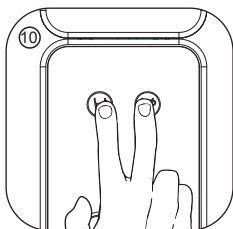

Press the Espresso and Lungo buttons simultaneously for 5s once again to exit descaling mode.

Water hardness:

| | fH | dH | CaCO ₃ | Descaling after: ☕ (40ml) | |
|-----------|----|----|-------------------|------------------------------|-------------------------------------|
| H(HIGH) | 36 | 20 | 360 mg/l | 300 | fH French Grade |
| M(MEDIUM) | 18 | 10 | 180 mg/l | 600 | dH German Grade |
| L(LOW) | 0 | 0 | 0 mg/l | 1200 | CaCO ₃ Calcium Carbonate |

Warning

1. Warning for short of water

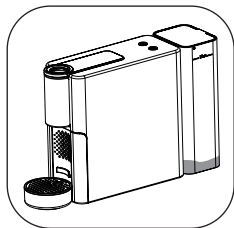

Water tank is out of water during work.

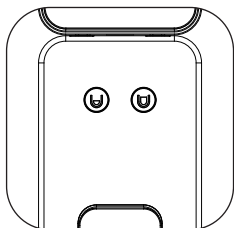

Lungo and espresso buttons flash 1s at a frequency of 3 times/s and stop 2s, cycle in turn.

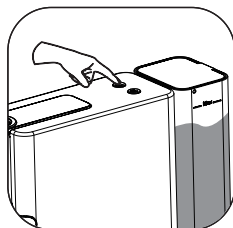

Fill up the tank, press any volume button to cancel warning.

2. Warning for overheat

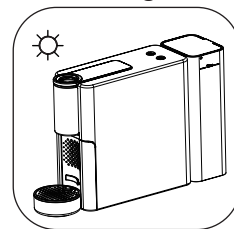

When the machine works continuously, and the boiler surface temperature reaches around 140 °C, the boiler will stop heating.

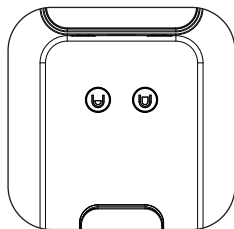

The indicator of Lungo button blink at a frequency of 3 times/s. The machine can't work normally.

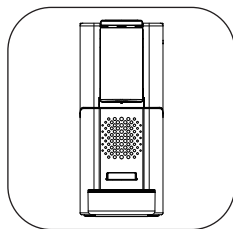

Plug off to cancel the warning, rest for 8 min and turn on, the machine will operate normally.

3. Warning for NTC error

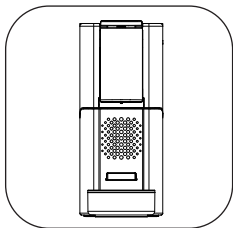

The machine shuts down, both boiler and pump stop working when there is an NTC error.

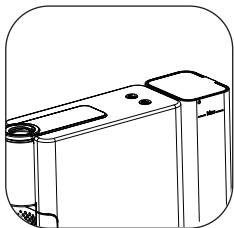

The Espresso and Lungo indicators flash alternatively at a frequency of 2 times/s.

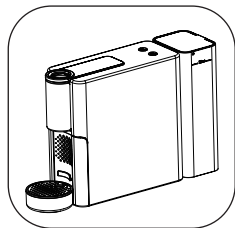

Please contact your dealer for service.

4. Overuse Alarm

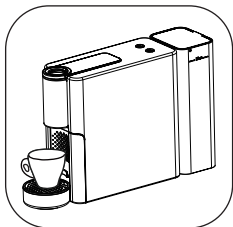

When the machine works continuously to run 1.5 L water, the machine program will alarm for overuse.



The lungo and espresso buttons flash 3 times/s per second. The machine exits the overuse alarm automatically after 30 minutes of rest. (During the alarm, it enters power-saving mode after 8 minutes but does not cancel the alarm.)

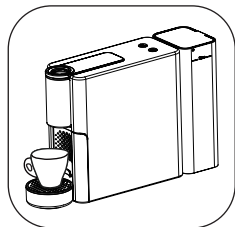

If unplugged during alarm, the machine works normally after reboot if boiler $<65^{\circ}\text{C}$. If two cups are over 2 minutes apart, the 1.5L count resets.

Cleaning & care

1. Daily cleaning

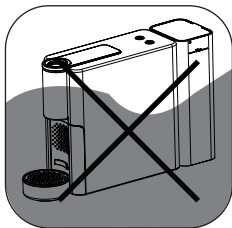

Do not immerse the machine in water. Electric shock.

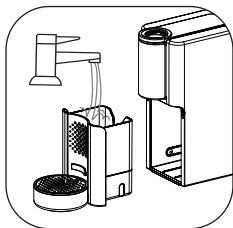

Rinse capsule container.

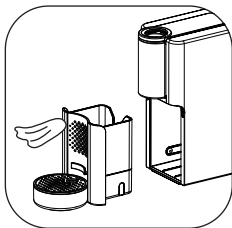

Clean drip tray and drip grid.



To clean water tank by clear water.

Troubleshooting

- | | | |
|----------|-------------------------------------|--|
| a | The indicator light is not on | <ul style="list-style-type: none">▶ ·Check plug.▶ ·Check if voltage is same as specified on rating label. |
| b | Buttons do not function | <ul style="list-style-type: none">▶ ·Plug off and plug on again▶ ·Call service center |
| c | Handle cannot be fully pressed down | <ul style="list-style-type: none">▶ ·Check if there is any foreign matter or capsule stuck in chamber.▶ ·Check if the capsule is as designated.▶ ·Call service center. |
| d | Coffee flow is not stable | <ul style="list-style-type: none">▶ ·Check water tank and make sure it is in position.▶ ·Check capsule and make sure it is in position. |
| e | No coffee is brewed | <ul style="list-style-type: none">▶ ·Replace a new capsule. |
| f | Water is not pumped | <ul style="list-style-type: none">▶ ·Check water tank.▶ ·Make sure water tank is in position.▶ ·Call service center. |
| g | Other problems | <ul style="list-style-type: none">▶ ·Call service center. |

Technical parameters



220-240V~ 50-60Hz 1200-1400W



20 bar



~ 2.7 kg



800ml



5 °C- 40 °C



337mm



90mm



213mm

Please search user manual at www.cino.cn.

My Barista

